

-  9900 383
-  9900 296
-  9900 78
-  9900 291
-  9900 34
-  9900 137
-  9900 48
-  9900 126
-  9900 127

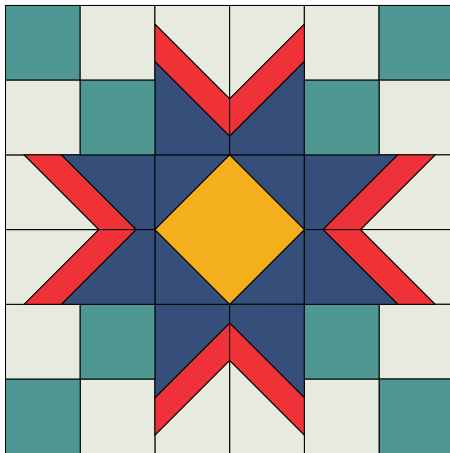

INGREDIENTS

12" BLOCK

FROM FABRIC 1 (TEAL), CUT:

- * [A] (8) 2½" squares

FROM FABRIC 2 (RED), CUT:

- * [B] (8) 3½" squares

FROM FABRIC 3 (NAVY), CUT:

- * [C] (12) 2¾" squares

FROM FABRIC 4 (YELLOW), CUT:

- * [D] (1) 4½" square

FROM BACKGROUND FABRIC, CUT:

- * [A] (8) 2½" squares

- * [D] (4) 4½" squares

WILDFLOWER

by Megan McGuire

FEATURING:

Lady Bird
by Crystal Manning

YIELD 12" block

STEP 1. MAKE 4-PATCHES

Using (1) teal $2\frac{1}{2}$ " square and (1) background $2\frac{1}{2}$ " square, sew together to make a 2-patch unit. Repeat for a total of (8) 2-patch units.

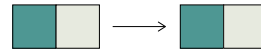

Now, using (2) of the 2-patch units, construct a 4-patch. Repeat for a total of (4) 4-patch units.

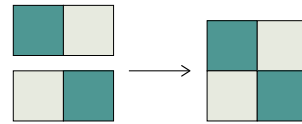

STEP 2. MAKE PETALS

On the wrong side of the (8) red $3\frac{1}{2}$ " squares mark a diagonal line corner to corner. Sew on the line. Trim $\frac{1}{4}$ " from sewn line. Press toward red.

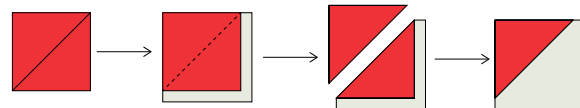

Place a second $3\frac{1}{2}$ " background square on the adjacent corner right sides together. Repeat the steps above.

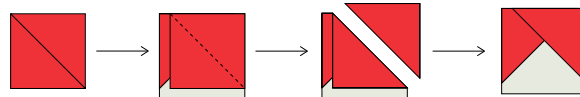

Repeat for a total of (4) $4\frac{1}{2}$ " background squares.

On the wrong side of (8) $2\frac{3}{4}$ " navy squares mark a diagonal line corner to corner. Place one $2\frac{3}{4}$ " navy square on the corner of the first red square added right sides together. Sew on the line. Trim $\frac{1}{4}$ " from the sewn line. Press toward navy.

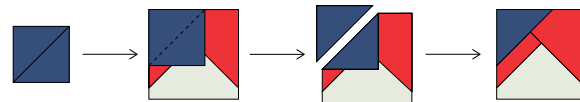

Place a second $2\frac{3}{4}$ " navy square on the adjacent corner right sides together. Sew on the line. Trim $\frac{1}{4}$ " from the sewn line. Press toward navy. Repeat for all (4) $4\frac{1}{2}$ " square units.

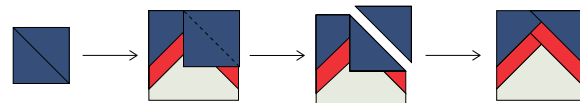

STEP 3. MAKE CENTER

Using the (4) $2\frac{3}{4}$ " navy squares mark a diagonal line from corner to corner. Place (1) navy square on one corner of the yellow $4\frac{1}{2}$ " square right sides together. Stitch on the line. Trim $\frac{1}{4}$ " from sewn line. Press toward navy. Place (1) navy square on the opposite corner on the yellow square right sides together. Stitch on the line. Trim $\frac{1}{4}$ " from sewn line. Press toward navy. Place (1) navy $2\frac{3}{4}$ " square on a corner that does not already have a navy square added to it right sides together. Stitch on the line. Trim $\frac{1}{4}$ " from sewn line. Press toward navy. Place the last navy square on the last corner of the yellow square. Stitch on the line. Trim $\frac{1}{4}$ " from sewn line. Press toward navy.

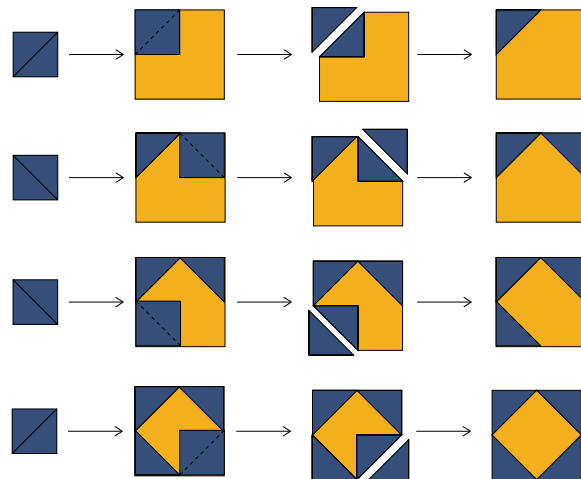

STEP 4. ASSEMBLE BLOCK

Lay out block components as shown. Join together.
Press well.

